



- ▶ PRECISION
- ▶ PRODUCTIVITY
- ▶ INNOVATION

AFFOLTER
AFFOLTER TECHNOLOGIES SA

GEAR AF101

TECHNICAL CHARACTERISTICS

Max. part diameter (hob cutter \varnothing 24 mm)	36 mm
Max. cutting length	50 mm
Max. module DP (depending on material and process used)	0.5-0.8 mm / 50-32 DP
Max. diameter of the cutter	24 mm
Max. length of the cutter	25 mm
Angle of inclination of the cutter in automatic mode to the left	30°
Angle of inclination of the cutter in automatic mode to the right	30°
Rotation of the cutting spindle	16'000 rpm
Dimensions (L x W x H)	1492x1470x1875 mm
Weight	1300 kg

COMPUTER NUMERIC CONTROL CNC

- CNC-control Affolter type AGIL8-10
- LCD graphic screen with 52 keys
- High speed Interpolation DHI (Direct Hardware Interpolation)
- Simple, user-friendly operating
- Possibility to network the machines and download the programs on a PC or a server



AUTOMATION

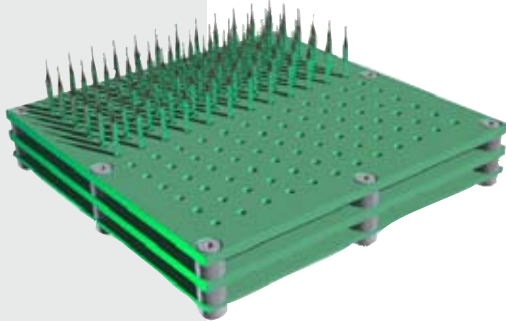

The AF101 offers a variety of automated applications with a high degree of flexibility and design.

- CNC robot loader
- Adaptation of other types of loaders on request

EXEMPLES OF APPLICATIONS

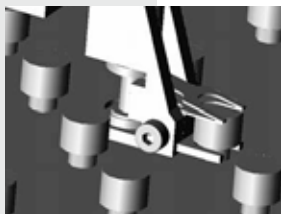

Unique part load/unload units



Dental tools



Straight Bevels & Face Gears



AFFOLTER TECHNOLOGIES SA
GRAND-RUE 76
CH-2735 MALLERAY

TEL: +41 32 491 70 00
FAX: +41 32 491 70 05

www.affoltergroup.ch
info@affoltergroup.ch